



City of El Cajon
Building and Fire Safety Division
 200 E. Main St.
 El Cajon, CA 92020
 (619) 441-1726, 1727

Typical Plot Plan for Plan Submission

A plot plan is required with all plan submittals. Please adhere to the following guidelines when preparing your plot plan.

1. The plot plan should be on a sheet of paper large enough to show all of the information. Minimum size is 8-1/2"x11"
2. Show a North direction arrow on your plot plan.
3. Indicate the scale of your drawing. i.e. One inch equals ten feet.
4. Indicate the area and dimensions of the parcel.
5. Provide the Assessor Parcel Number on the plan.
6. Show location, names and widths of bordering or on-site streets, road easements and alleys.
7. Show all utility and/or open space easements. Indicate the use of the easement and dimensions.
8. Show location and width of interior driveways.
9. Show locations and dimensions of all existing and proposed buildings, structures, parking and landscape areas.
10. State the use of all buildings and structures.
11. Show all distances from buildings to property lines or road/street easements and centerlines.
12. Show distances between buildings.
13. Indicate location of all slope and banks.

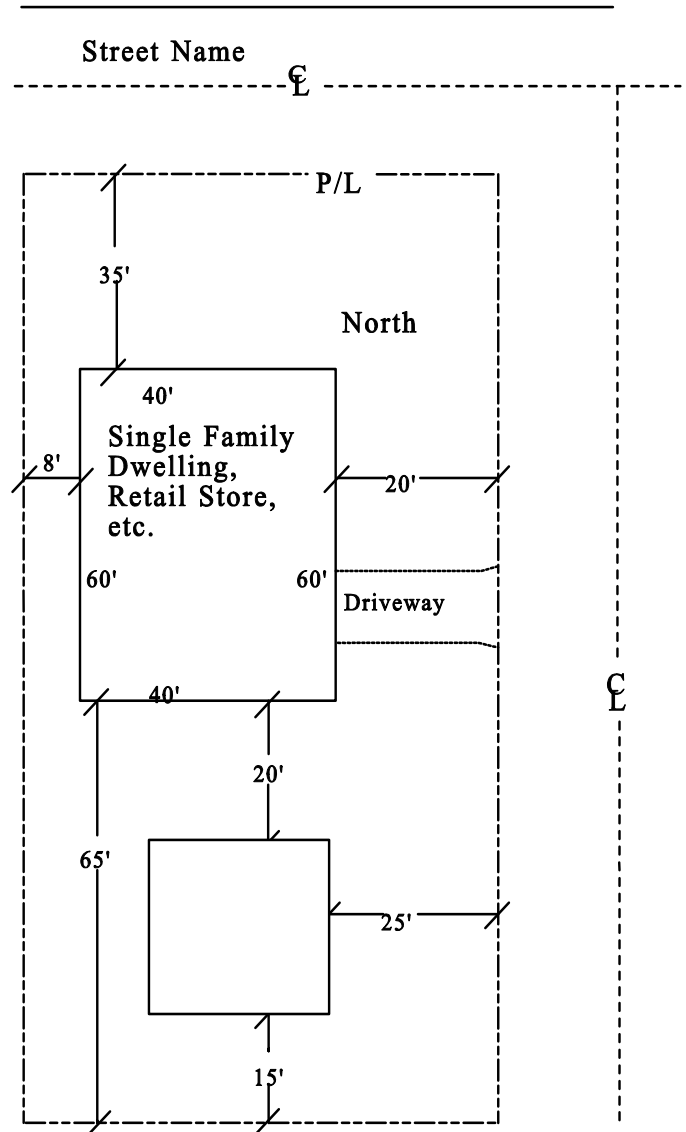

Property Address
 Legal Description
 Assessor's Parcel Number

Scale

For information concerning zoning regulations please contact the Planning Division at (619) 441-1741.